

SIDE ELEVATION ON RIGHT ABUTMENT
1:50

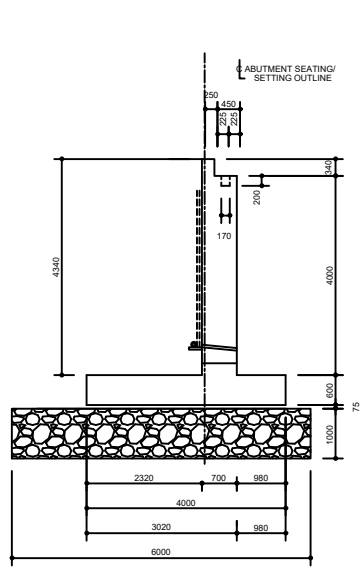

SECTION A-A
1:50

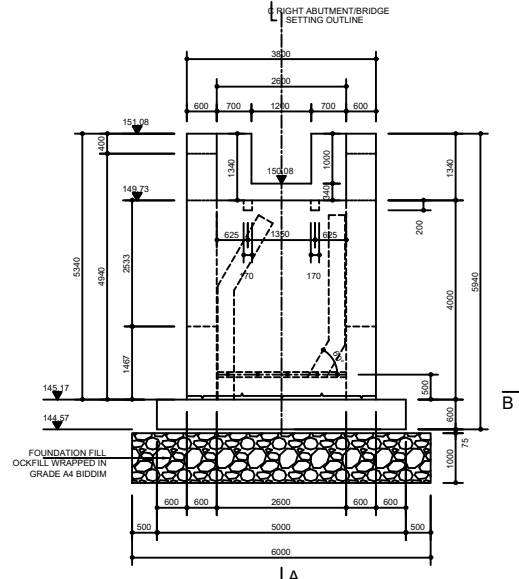

FRONT ELEVATION ON RIGHT ABUTMENT
1:50

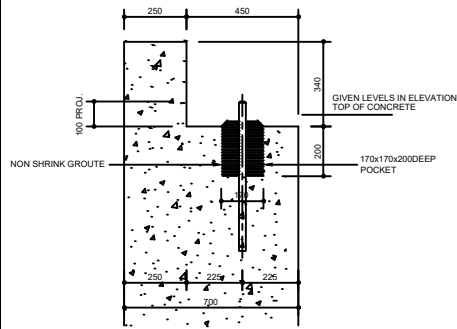

LEFT ABUTMENT BEARING DETAIL
SCALE 1:10

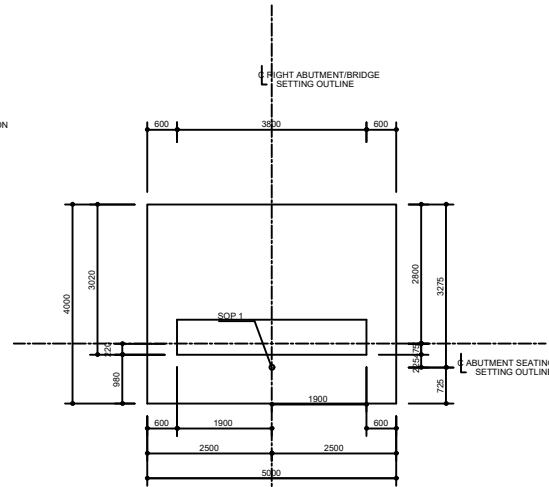

SECTION B - B
1:50

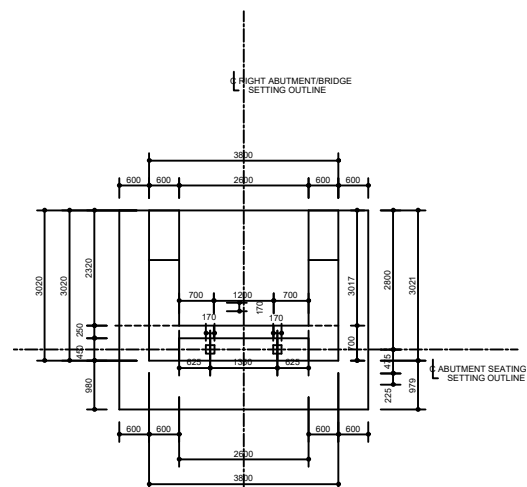

PLAN ON RIGHT ABUTMENT
1:50



REFERENCE DRAWINGS No. _____		DESIGNED M. NCUBE CHECKED G.MLAMBO DRAWN M. NCUBE CHECKED G.MLAMBO PROJ. ENGR. G.MLAMBO		TEL: (033) 346 0888 FAX: (033) 346 0882 E-mail: ziyanda@ziyandacconsulting.co.za PO BOX 809 ALTON 6350 SPRUITZBURG 3245 APPROVED: _____ S. MOUTSHI (P.E. ENG. REG. No. 20040308)		 RAY NKONYENI MUNICIPALITY		PROJECT/DRAWING TITLE RAY NKONYENI LOCAL MUNICIPALITY CONSTRUCTION MBHELE PEDESTRIAN BRIDGE IN MVUTSHIN, WARD 29 RIGHT ABUTMENT CONCRETE DETAILS		DRAWING STATUS ISSUED FOR TENDER	
0 ISSUED FOR TENDER REVISIONS ONLY REVISIONS MARKED THIS ARE VALID		11/23 G.M DWE OWD APPRV		ALT. DWG. No. 8/2/RNM.0491		CONTRACT No. 8/2/RNM.0491		SHT. No. 2 OF 2 PROJECT No. J161		DRAWING No. J161-D02	
								REVISION 			